



## CHARLESTON PARK

First Floor



Second Floor

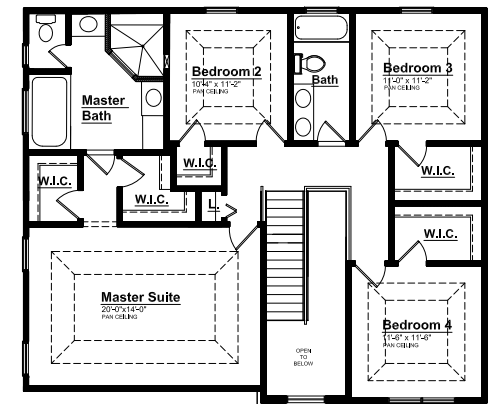

### THE ADDISON - Colonial - \$429,900

222 SINGH BLVD. SOUTH LYON, MI | 2,369 SF | HOMESITE #78

#### INCLUDED FEATURES:

- ◆ Expanded Nook and Kitchen with Social Island
- ◆ Gourmet Kitchen Layout
- ◆ Walk-in Kitchen Pantry
- ◆ Stainless Steel Appliances
- ◆ 42" Maple Kitchen Cabinets
- ◆ Laundry Rm with Window off Mudroom
- ◆ Granite Countertops Throughout
- ◆ Three Car Front Entry Garage
- ◆ Stained Railing & Painted Spindles
- ◆ First Floor Flex Room with French Doors
- ◆ Pan Ceilings at all Secondary Bedrooms
- ◆ Walk-In Closets at all secondary Bedrooms
- ◆ Elite Master Suite with Luxury Shower
- ◆ Hardwood Floors in all Common Areas
- ◆ Secondary Bathroom with window
- ◆ 9' First Floor Ceiling Height
- ◆ Two Story Foyer Ceilings
- ◆ 8' tall Carriage style Garage Doors
- ◆ 12 Month Builder Warranty
- ◆ 10 yr. Basement Warranty
- ◆ Tremco Waterproofing System

#### FOR MORE INFORMATION PLEASE CONTACT:

 **JYOTI BANIPAL**  
SALES MANAGER

 Jyoti.Banipal@singhmail.com

 248.516.9934

 115 Singh BLVD. South Lyon, MI

 Mon, Tues, Fri: Noon - 5p.m.  
Sat - Sun: Noon - 6p.m.